

Aviva Formel-San

4075050070

Special interior-paint with film protection against mould and fungal decay for DIY and professional use.

PRODUCT DESCRIPTION

General

Breathable, water-based dispersion paint for internal walls with film protection for rooms prone to mould as well as in combination with Aviva Schimmelex 8309000200 or Aviva Fungisan 8308000210 for the renovation of inner surfaces infested by mould.

The excellent covering and odourless product is easy to use and formulated without any addition of solvents and plasticizers.

Special properties and standards

- The coating is protected against blue stain and mould by a biocidal active substance.

Active substances

0,2 % IPBC (Iodpropinylbutylcarbamate)

- **ÖNORM EN 13300**

Wet abrasion resistance: class 2

Contrast ratio (covering power): class 2 (for 7 m²/l)

Degree of gloss: dull matt

Maximum grain size: fine (< 100 µm)

- **French ordinance DEVL1104875A** regarding the marking of construction coating products for their emission of volatile pollutants: A+



Application area



Internal surfaces prone to mould in moist rooms for professional use such as creamery, brewery, abattoirs as well as a support for room hygiene in kitchens, bathrooms and private living areas.

PROCESSING

Instructions for use

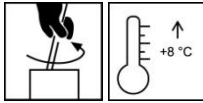

- Please stir the product before use.
- Do not apply if temperatures are below + 8 °C and / or relative atmospheric humidity > 80 %.
- Apply the coat at one stroke to avoid wet-on-wet crusts.
- Signs of touch-up work on the surface depend on several factors and hence, cannot be avoided (BFS data sheet 25).
- Do not recoat permanently elastic joint masses and sealing profiles (may lead to formation of cracks or fading of the coat)!
- Remove paint splashes immediately with water.

Application technique

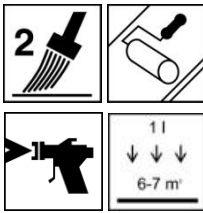

Application method	Brushing	Rolling	Airless pressurized (Airmix, Aircoat, etc.)
Spraying nozzle (ø mm)	-	-	0,53 – 0,63
Spraying nozzle (ø inch)	-	-	0,021 – 0,026
Spraying angle (degrees)	-	-	50
Spraying pressure (bar)	-	-	150 – 180
Fine strainer	-	-	0,2 mm
Dilution (thinning)	water		
Thinner amount added in %	max. 5		
Consumption ml/m ²	ca. 145		ca. 170
Yield per application (m ² /l) ¹⁾	ca. 7		ca. 6
¹⁾ Yield including addition of thinner and loss while spraying			

The shape and properties of the substrate and wood moisture affect the consumption / yield. Accurate values for consumption must be obtained by applying trial coats in advance.

Drying times

(at 23 °C and 50 % rel. humidity)



Recoatable	after approx. 3 - 4 hours
------------	---------------------------

The figures given above are reference values. The drying time depends on the substrate, coat thickness, temperature, air exchange and relative atmospheric humidity.

Lower temperatures and / or high level of atmospheric humidity can increase the drying time considerably.

Cleaning the working equipment

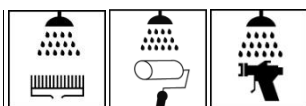

With water immediately after use.

Remove dried paint residues with ADLER Aqua-Cleaner 80080 or ADLER Abbeizer Rote Krähe 95125.

SUBSTRATE

Type of substrate	Mineral plasters, gypsum plaster, concrete, gypsum plaster boards and recoatable old coatings.
Substrate property (or condition)	<p>The substrate must be dry, clean and free from any separating substances, and it must be checked to see whether it is suitable and capable of being recoated.</p> <p>Please observe and follow ÖNORM B 2230 Part 2.</p> <p>See also VOB, DIN 18363, Part C, paragraph 3; Painting and coating work.</p> <p>Any coatings that cannot be recoated must be removed thoroughly.</p>
Preparation of the substrate	<ul style="list-style-type: none"> • Touch up small cracks, holes or unevenness using suitable wood filler. • Thoroughly remove greasy or oily impurities using ADLER Entfetter (degreaser) 80394. • No pre-treatment is necessary for clean, slightly absorbent, dry and recoatable substrates. • Mould infestation has to be treated with Aviva Schimmelex 8309000200 or Aviva Fungisan 8308000210. <p>A durable renovation is not possible without elimination of the cause!</p> <p>Plasters of the mortar groups P II and P III Allow new plaster application to remain untreated for three to four weeks. Re-plastered patches must be set well and dried up and, if required, seal them with fluosilicate. On coarsely porous and slightly sanding or absorbent surfaces, apply a primer coat with Aviva Tiefengrund WV 4074000200.</p> <p>Gypsum and readymade plasters of the mortar groups P IV and P V Grind off any sintered coat remaining. On coarsely porous and slightly sanding or absorbent surfaces, apply a primer coat with Aviva Tiefengrund WV 4074000200.</p> <p>Gypsum plaster boards (GKP) Grind off wood filler burrs. Apply one primer coat using Aviva Tiefengrund WV 4074000200 diluted 1:1 with water.</p> <p>Concrete surfaces Remove dirt deposits, separating agents or powder layers through mechanical cleaning. On coarsely porous and slightly sanding or absorbent surfaces, apply a primer coat with Aviva Tiefengrund WV 4074000200.</p> <p>Coats that can be recoated Work directly on matt and poorly absorbent coatings. On coarsely porous, slightly sanding or absorbent surfaces apply a primer coat using Aviva Tiefengrund WV 4074000200. Glossy or smooth substrates (as paint or latex substrates, sinter layer) leach, roughen or grind.</p> <p>Glue-bound distempers Wash-off thoroughly and apply a primer coat using Aviva Tiefengrund WV 4074000200.</p> <p>Avoid a glossy drying of Aviva Tiefengrund WV 4074000200!</p> <p>Please observe the relative technical data sheets of the products.</p>

COATING SYSTEM

Primer coat	See substrate preparation
Intermediate coat	Aviva Formel-San 4075050070 diluted with max. 5 % of water.
Final coat	Aviva Formel-San 4075050070 without thinning Products containing active substances must have a sufficient film thickness. Generally this can be ensured with a two layers application (application quantity: minimum 250 ml/m ²).

ORDERING INFORMATION

Size of trading unit	0,75 l, 3 l; 9 l
Colour shades	Weiß 4075050070
Color4You 	More colour shades can be obtained using the ADLER colour blending system Colour4you..
	<ul style="list-style-type: none"> In order to ensure uniformity of the colour shade, use material having the same batch number on a given surface. Nonetheless, it is recommended to prepare a trial colour sample on the original substrate using the coating system selected in order to assess the final colour shade.

Supplementary products	Aviva Tiefengrund WV 4074000200 Aviva Schimmelex 8309000200 Aviva Fungisan 8308000210 ADLER Abbeizer Rote Krähe 95125 ADLER Entfetter 80394
-------------------------------	---

FURTHER DETAILS

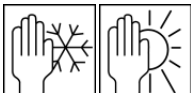
Durability/storage	At least 1 year in the original sealed containers.
	Store it such that it is protected against moisture, direct sunlight, frost and high temperatures (above 30 °C).

Technical specifications	VOC-content	EU-limit for Aviva Formel-San (Kat. A/a): 30 g/l (2010). Aviva Formel-San contains < 1 g/l VOC.
---------------------------------	-------------	---

Product code for paints and varnishes	M-DF01F
--	---------

Safety-related information	Please follow the associated safety data sheet! The latest version can be retrieved from the Internet at www.adler-lacke.com .
	Recycle only those containers whose residues have been emptied out. You may dispose of liquid material residues as water-based paint and varnish waste and dried-up material residues as cured paints or as household garbage.